

U.S. ROUTE 15  
(CATOCTIN MOUNTAIN HIGHWAY)  
M.S.R.C. PLAT NO. 24985, 24986, 24987 & 37029  
(NEAREST EDGE OF PAVEMENT 175'± TO ROW LINE)

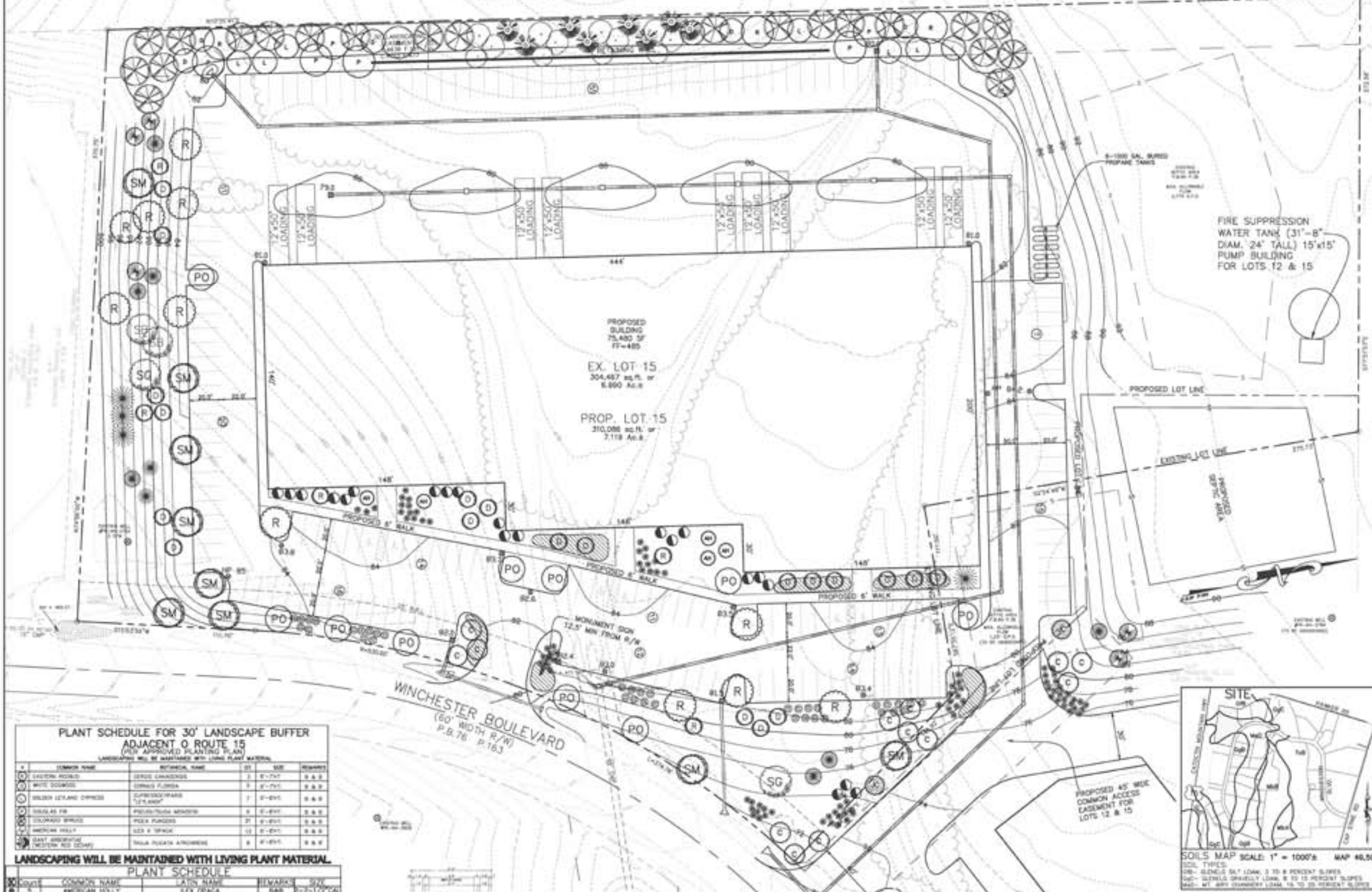

**BASE NOTES**

- HORIZONTAL DATUM BASED ON PLAT OF SUBDIVISION ENTITLED "STANFORD INDUSTRIAL PARK PLAT LOT 15, SECTION 1, STAFFORD INDUSTRIAL PARK" RECORDED IN PLAT BOOK 41 PAGE 25.
- VERTICAL DATUM BASED ON U.S.S. BENCH MARK FOUND ON LOT 15. ELEVATION ON EAST SIDE OF CURB SIDE WALK IS 4'± NORTH OF BENCHMARK. ROAD INTERSECTION WHERE STANFORD "U.S.S. BENCH MARK" WAS LOCATED IS 175'± TO ROW LINE.
- EXISTING UTILITIES AND DEPTH FROM AVAILABLE RECORDS. THESE LOCATIONS SHOULD BE CONFIRMED BY FIELD SURVEY AND SHOULD BE INDICATED BEFORE CONSTRUCTION.
- PROPOSED LOT LINE IS A 30'± WIDE COMMON ACCESS EASEMENT FOR LOT 15. THIS EASEMENT IS NOT TO BE USED FOR ANY OTHER PURPOSES. ANY OTHER INFORMATION OF RECORD, SURVEY AND ASSOCIATED DATA SHOULD BE OBTAINED BY THE CLIENT PRIOR TO THE DATE OF THIS PLAN.
- THIS PLAN PREPARED WITHOUT THE BENEFIT OF A FIELD SURVEY.
- A 30'± (30') WIDE AND UTILITY EASEMENT IS RESERVED ALONG ALL LOT LINES.

**SEE PLAN NOTES LOT 15**

- EXISTING UTILITIES AND DEPTH FROM AVAILABLE RECORDS. THESE LOCATIONS SHOULD BE CONFIRMED BY FIELD SURVEY AND SHOULD BE INDICATED BEFORE CONSTRUCTION.
- PROPOSED LOT LINE IS A 30'± WIDE COMMON ACCESS EASEMENT FOR LOT 15. THIS EASEMENT IS NOT TO BE USED FOR ANY OTHER PURPOSES. ANY OTHER INFORMATION OF RECORD, SURVEY AND ASSOCIATED DATA SHOULD BE OBTAINED BY THE CLIENT PRIOR TO THE DATE OF THIS PLAN.
- THIS PLAN PREPARED WITHOUT THE BENEFIT OF A FIELD SURVEY.
- A 30'± (30') WIDE AND UTILITY EASEMENT IS RESERVED ALONG ALL LOT LINES.

**SOILS MAP SCALE: 1" = 1000'± MAP 46.50**

SOILS: TYPICAL  
 SCL - SLENDRE SILT LOAM, 3 TO 8 PERCENT SLOPES  
 SCLG - SLENDRE GRAVELLY LOAM, 8 TO 15 PERCENT SLOPES  
 SCLG - WT. SAND GRAVELLY LOAM, 15 TO 25 PERCENT SLOPES

**PLANT SCHEDULE FOR 30' LANDSCAPE BUFFER ADJACENT TO ROUTE 15 (PER APPROVED PLANTING PLAN)**  
LANDSCAPING WILL BE MAINTAINED WITH LIVING PLANT MATERIAL.

| COMMON NAME                      | BOTANICAL NAME           | HT | SPR    | REMARKS |
|----------------------------------|--------------------------|----|--------|---------|
| GREYTON PINE                     | SPRUS LINDENSIS          | 3  | 6'-7'± | 6-8-2   |
| WHITE DOGWOOD                    | CORNUS FLORIDA           | 3  | 6'-7'± | 6-8-2   |
| BURSH LEYLAND CYPRESS            | CUPRESSUS FLORIDA 'TETRA | 7  | 6'-8'± | 6-8-2   |
| SMALL AS FIB                     | PRUNUS TRUNCATA MINOR    | 3  | 6'-8'± | 6-8-2   |
| DOGWOOD BRIDGE                   | PRUNUS SPENCER           | 27 | 6'-8'± | 6-8-2   |
| AMERICAN HAWK                    | QUERCUS LAEVOGATA        | 11 | 6'-8'± | 6-8-2   |
| EAST SPINDLE (WESTERN RED CEDAR) | TAXUS RUSCATA ATROBREVIS | 6  | 6'-8'± | 6-8-2   |

**LANDSCAPING WILL BE MAINTAINED WITH LIVING PLANT MATERIAL.**

**PLANT SCHEDULE**

| NO. | COMMON NAME                      | BOTANICAL NAME           | HT | SPR    | REMARKS |
|-----|----------------------------------|--------------------------|----|--------|---------|
| 1   | DOGWOOD BRIDGE                   | PRUNUS SPENCER           | 27 | 6'-8'± | 6-8-2   |
| 2   | SMALL AS FIB                     | PRUNUS TRUNCATA MINOR    | 3  | 6'-8'± | 6-8-2   |
| 3   | GREYTON PINE                     | SPRUS LINDENSIS          | 3  | 6'-7'± | 6-8-2   |
| 4   | WHITE DOGWOOD                    | CORNUS FLORIDA           | 3  | 6'-7'± | 6-8-2   |
| 5   | BURSH LEYLAND CYPRESS            | CUPRESSUS FLORIDA 'TETRA | 7  | 6'-8'± | 6-8-2   |
| 6   | AMERICAN HAWK                    | QUERCUS LAEVOGATA        | 11 | 6'-8'± | 6-8-2   |
| 7   | EAST SPINDLE (WESTERN RED CEDAR) | TAXUS RUSCATA ATROBREVIS | 6  | 6'-8'± | 6-8-2   |
| 8   | RED MAPLE                        | ACER RUBRUM              | 24 | 6'-8'± | 6-8-2   |
| 9   | RED TWIG DOGWOOD                 | CORNUS SERICEA           | 10 | 6'-8'± | 6-8-2   |
| 10  | DOGWOOD BRIDGE                   | PRUNUS SPENCER           | 27 | 6'-8'± | 6-8-2   |
| 11  | SMALL AS FIB                     | PRUNUS TRUNCATA MINOR    | 3  | 6'-8'± | 6-8-2   |
| 12  | GREYTON PINE                     | SPRUS LINDENSIS          | 3  | 6'-7'± | 6-8-2   |
| 13  | WHITE DOGWOOD                    | CORNUS FLORIDA           | 3  | 6'-7'± | 6-8-2   |
| 14  | BURSH LEYLAND CYPRESS            | CUPRESSUS FLORIDA 'TETRA | 7  | 6'-8'± | 6-8-2   |
| 15  | AMERICAN HAWK                    | QUERCUS LAEVOGATA        | 11 | 6'-8'± | 6-8-2   |
| 16  | EAST SPINDLE (WESTERN RED CEDAR) | TAXUS RUSCATA ATROBREVIS | 6  | 6'-8'± | 6-8-2   |
| 17  | RED MAPLE                        | ACER RUBRUM              | 24 | 6'-8'± | 6-8-2   |
| 18  | RED TWIG DOGWOOD                 | CORNUS SERICEA           | 10 | 6'-8'± | 6-8-2   |
| 19  | DOGWOOD BRIDGE                   | PRUNUS SPENCER           | 27 | 6'-8'± | 6-8-2   |
| 20  | SMALL AS FIB                     | PRUNUS TRUNCATA MINOR    | 3  | 6'-8'± | 6-8-2   |
| 21  | GREYTON PINE                     | SPRUS LINDENSIS          | 3  | 6'-7'± | 6-8-2   |
| 22  | WHITE DOGWOOD                    | CORNUS FLORIDA           | 3  | 6'-7'± | 6-8-2   |
| 23  | BURSH LEYLAND CYPRESS            | CUPRESSUS FLORIDA 'TETRA | 7  | 6'-8'± | 6-8-2   |
| 24  | AMERICAN HAWK                    | QUERCUS LAEVOGATA        | 11 | 6'-8'± | 6-8-2   |
| 25  | EAST SPINDLE (WESTERN RED CEDAR) | TAXUS RUSCATA ATROBREVIS | 6  | 6'-8'± | 6-8-2   |
| 26  | RED MAPLE                        | ACER RUBRUM              | 24 | 6'-8'± | 6-8-2   |
| 27  | RED TWIG DOGWOOD                 | CORNUS SERICEA           | 10 | 6'-8'± | 6-8-2   |
| 28  | DOGWOOD BRIDGE                   | PRUNUS SPENCER           | 27 | 6'-8'± | 6-8-2   |
| 29  | SMALL AS FIB                     | PRUNUS TRUNCATA MINOR    | 3  | 6'-8'± | 6-8-2   |
| 30  | GREYTON PINE                     | SPRUS LINDENSIS          | 3  | 6'-7'± | 6-8-2   |
| 31  | WHITE DOGWOOD                    | CORNUS FLORIDA           | 3  | 6'-7'± | 6-8-2   |
| 32  | BURSH LEYLAND CYPRESS            | CUPRESSUS FLORIDA 'TETRA | 7  | 6'-8'± | 6-8-2   |
| 33  | AMERICAN HAWK                    | QUERCUS LAEVOGATA        | 11 | 6'-8'± | 6-8-2   |
| 34  | EAST SPINDLE (WESTERN RED CEDAR) | TAXUS RUSCATA ATROBREVIS | 6  | 6'-8'± | 6-8-2   |
| 35  | RED MAPLE                        | ACER RUBRUM              | 24 | 6'-8'± | 6-8-2   |
| 36  | RED TWIG DOGWOOD                 | CORNUS SERICEA           | 10 | 6'-8'± | 6-8-2   |
| 37  | DOGWOOD BRIDGE                   | PRUNUS SPENCER           | 27 | 6'-8'± | 6-8-2   |
| 38  | SMALL AS FIB                     | PRUNUS TRUNCATA MINOR    | 3  | 6'-8'± | 6-8-2   |
| 39  | GREYTON PINE                     | SPRUS LINDENSIS          | 3  | 6'-7'± | 6-8-2   |
| 40  | WHITE DOGWOOD                    | CORNUS FLORIDA           | 3  | 6'-7'± | 6-8-2   |
| 41  | BURSH LEYLAND CYPRESS            | CUPRESSUS FLORIDA 'TETRA | 7  | 6'-8'± | 6-8-2   |
| 42  | AMERICAN HAWK                    | QUERCUS LAEVOGATA        | 11 | 6'-8'± | 6-8-2   |
| 43  | EAST SPINDLE (WESTERN RED CEDAR) | TAXUS RUSCATA ATROBREVIS | 6  | 6'-8'± | 6-8-2   |
| 44  | RED MAPLE                        | ACER RUBRUM              | 24 | 6'-8'± | 6-8-2   |
| 45  | RED TWIG DOGWOOD                 | CORNUS SERICEA           | 10 | 6'-8'± | 6-8-2   |
| 46  | DOGWOOD BRIDGE                   | PRUNUS SPENCER           | 27 | 6'-8'± | 6-8-2   |
| 47  | SMALL AS FIB                     | PRUNUS TRUNCATA MINOR    | 3  | 6'-8'± | 6-8-2   |
| 48  | GREYTON PINE                     | SPRUS LINDENSIS          | 3  | 6'-7'± | 6-8-2   |
| 49  | WHITE DOGWOOD                    | CORNUS FLORIDA           | 3  | 6'-7'± | 6-8-2   |
| 50  | BURSH LEYLAND CYPRESS            | CUPRESSUS FLORIDA 'TETRA | 7  | 6'-8'± | 6-8-2   |
| 51  | AMERICAN HAWK                    | QUERCUS LAEVOGATA        | 11 | 6'-8'± | 6-8-2   |
| 52  | EAST SPINDLE (WESTERN RED CEDAR) | TAXUS RUSCATA ATROBREVIS | 6  | 6'-8'± | 6-8-2   |
| 53  | RED MAPLE                        | ACER RUBRUM              | 24 | 6'-8'± | 6-8-2   |
| 54  | RED TWIG DOGWOOD                 | CORNUS SERICEA           | 10 | 6'-8'± | 6-8-2   |
| 55  | DOGWOOD BRIDGE                   | PRUNUS SPENCER           | 27 | 6'-8'± | 6-8-2   |
| 56  | SMALL AS FIB                     | PRUNUS TRUNCATA MINOR    | 3  | 6'-8'± | 6-8-2   |
| 57  | GREYTON PINE                     | SPRUS LINDENSIS          | 3  | 6'-7'± | 6-8-2   |
| 58  | WHITE DOGWOOD                    | CORNUS FLORIDA           | 3  | 6'-7'± | 6-8-2   |
| 59  | BURSH LEYLAND CYPRESS            | CUPRESSUS FLORIDA 'TETRA | 7  | 6'-8'± | 6-8-2   |
| 60  | AMERICAN HAWK                    | QUERCUS LAEVOGATA        | 11 | 6'-8'± | 6-8-2   |
| 61  | EAST SPINDLE (WESTERN RED CEDAR) | TAXUS RUSCATA ATROBREVIS | 6  | 6'-8'± | 6-8-2   |
| 62  | RED MAPLE                        | ACER RUBRUM              | 24 | 6'-8'± | 6-8-2   |
| 63  | RED TWIG DOGWOOD                 | CORNUS SERICEA           | 10 | 6'-8'± | 6-8-2   |
| 64  | DOGWOOD BRIDGE                   | PRUNUS SPENCER           | 27 | 6'-8'± | 6-8-2   |
| 65  | SMALL AS FIB                     | PRUNUS TRUNCATA MINOR    | 3  | 6'-8'± | 6-8-2   |
| 66  | GREYTON PINE                     | SPRUS LINDENSIS          | 3  | 6'-7'± | 6-8-2   |
| 67  | WHITE DOGWOOD                    | CORNUS FLORIDA           | 3  | 6'-7'± | 6-8-2   |
| 68  | BURSH LEYLAND CYPRESS            | CUPRESSUS FLORIDA 'TETRA | 7  | 6'-8'± | 6-8-2   |
| 69  | AMERICAN HAWK                    | QUERCUS LAEVOGATA        | 11 | 6'-8'± | 6-8-2   |
| 70  | EAST SPINDLE (WESTERN RED CEDAR) | TAXUS RUSCATA ATROBREVIS | 6  | 6'-8'± | 6-8-2   |
| 71  | RED MAPLE                        | ACER RUBRUM              | 24 | 6'-8'± | 6-8-2   |
| 72  | RED TWIG DOGWOOD                 | CORNUS SERICEA           | 10 | 6'-8'± | 6-8-2   |
| 73  | DOGWOOD BRIDGE                   | PRUNUS SPENCER           | 27 | 6'-8'± | 6-8-2   |
| 74  | SMALL AS FIB                     | PRUNUS TRUNCATA MINOR    | 3  | 6'-8'± | 6-8-2   |
| 75  | GREYTON PINE                     | SPRUS LINDENSIS          | 3  | 6'-7'± | 6-8-2   |
| 76  | WHITE DOGWOOD                    | CORNUS FLORIDA           | 3  | 6'-7'± | 6-8-2   |
| 77  | BURSH LEYLAND CYPRESS            | CUPRESSUS FLORIDA 'TETRA | 7  | 6'-8'± | 6-8-2   |
| 78  | AMERICAN HAWK                    | QUERCUS LAEVOGATA        | 11 | 6'-8'± | 6-8-2   |
| 79  | EAST SPINDLE (WESTERN RED CEDAR) | TAXUS RUSCATA ATROBREVIS | 6  | 6'-8'± | 6-8-2   |
| 80  | RED MAPLE                        | ACER RUBRUM              | 24 | 6'-8'± | 6-8-2   |
| 81  | RED TWIG DOGWOOD                 | CORNUS SERICEA           | 10 | 6'-8'± | 6-8-2   |
| 82  | DOGWOOD BRIDGE                   | PRUNUS SPENCER           | 27 | 6'-8'± | 6-8-2   |
| 83  | SMALL AS FIB                     | PRUNUS TRUNCATA MINOR    | 3  | 6'-8'± | 6-8-2   |
| 84  | GREYTON PINE                     | SPRUS LINDENSIS          | 3  | 6'-7'± | 6-8-2   |
| 85  | WHITE DOGWOOD                    | CORNUS FLORIDA           | 3  | 6'-7'± | 6-8-2   |
| 86  | BURSH LEYLAND CYPRESS            | CUPRESSUS FLORIDA 'TETRA | 7  | 6'-8'± | 6-8-2   |
| 87  | AMERICAN HAWK                    | QUERCUS LAEVOGATA        | 11 | 6'-8'± | 6-8-2   |
| 88  | EAST SPINDLE (WESTERN RED CEDAR) | TAXUS RUSCATA ATROBREVIS | 6  | 6'-8'± | 6-8-2   |
| 89  | RED MAPLE                        | ACER RUBRUM              | 24 | 6'-8'± | 6-8-2   |
| 90  | RED TWIG DOGWOOD                 | CORNUS SERICEA           | 10 | 6'-8'± | 6-8-2   |
| 91  | DOGWOOD BRIDGE                   | PRUNUS SPENCER           | 27 | 6'-8'± | 6-8-2   |
| 92  | SMALL AS FIB                     | PRUNUS TRUNCATA MINOR    | 3  | 6'-8'± | 6-8-2   |
| 93  | GREYTON PINE                     | SPRUS LINDENSIS          | 3  | 6'-7'± | 6-8-2   |
| 94  | WHITE DOGWOOD                    | CORNUS FLORIDA           | 3  | 6'-7'± | 6-8-2   |
| 95  | BURSH LEYLAND CYPRESS            | CUPRESSUS FLORIDA 'TETRA | 7  | 6'-8'± | 6-8-2   |
| 96  | AMERICAN HAWK                    | QUERCUS LAEVOGATA        | 11 | 6'-8'± | 6-8-2   |
| 97  | EAST SPINDLE (WESTERN RED CEDAR) | TAXUS RUSCATA ATROBREVIS | 6  | 6'-8'± | 6-8-2   |
| 98  | RED MAPLE                        | ACER RUBRUM              | 24 | 6'-8'± | 6-8-2   |
| 99  | RED TWIG DOGWOOD                 | CORNUS SERICEA           | 10 | 6'-8'± | 6-8-2   |
| 100 | DOGWOOD BRIDGE                   | PRUNUS SPENCER           | 27 | 6'-8'± | 6-8-2   |

**Harris, Smariga & Associates, Inc.**  
Planners/Engineers/Surveyors  
125 South Carroll Street, Suite 100, Frederick, MD 21701  
301-662-4466 / FAX 301-662-6908

**FINAL SITE PLAN**  
**STANFORD**  
**TRADING CENTER VIII**  
RECONFIGURED LOT 15 STANFORD INDUSTRIAL PARK SECTION 2

SCALE: 1" = 30'  
DRAWN BY: TGM  
CHECKED BY: SFZ  
DATE: FEBRUARY, 2008  
SHEET: 1 OF: 1  
PROJECT: 0289

FIG 84 P 38  
#850 WINCHESTER BOULEVARD  
BUCKEYSTOWN ELECTION DISTRICT #1  
FREDERICK COUNTY, MARYLAND

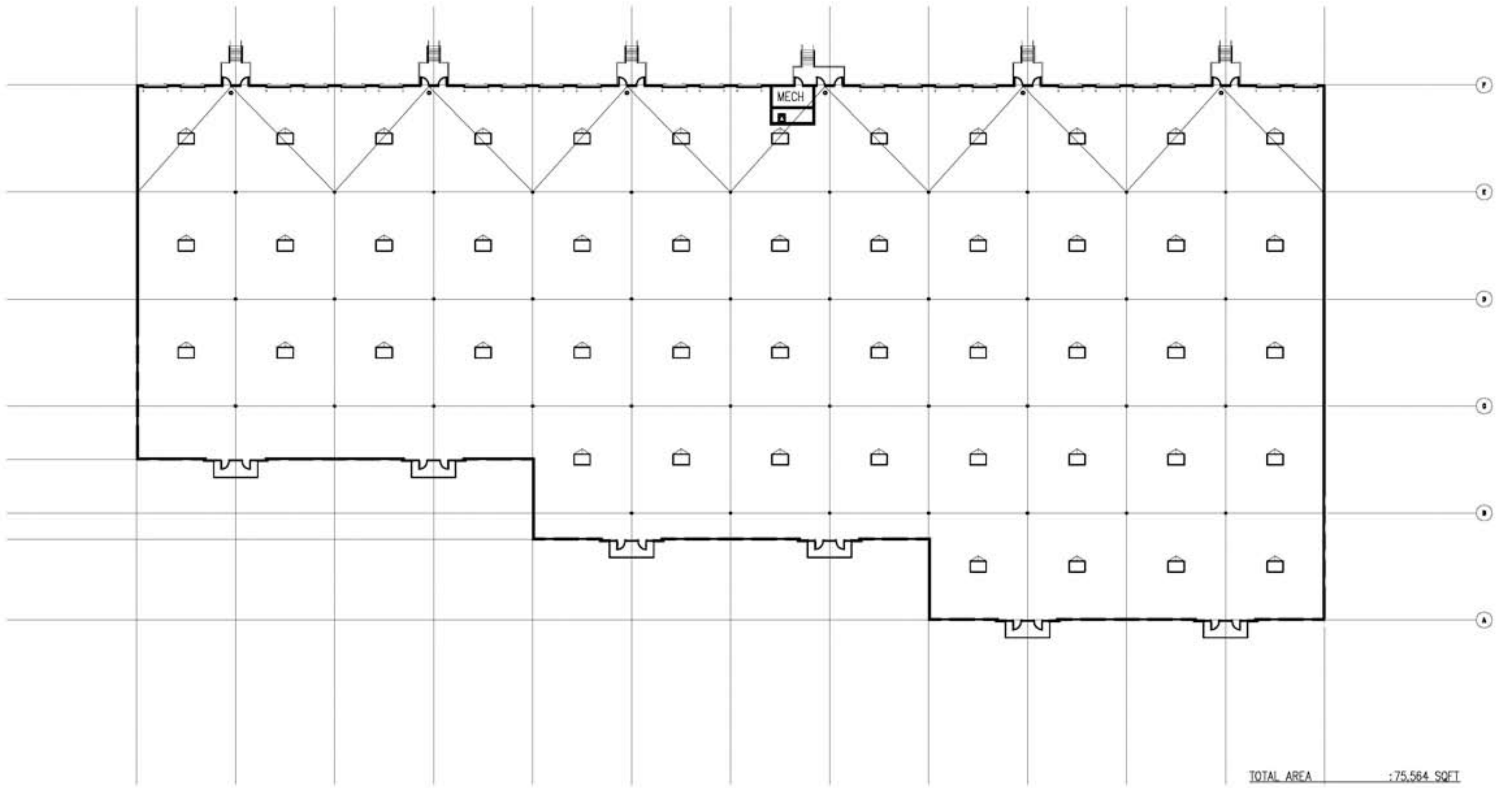

TOTAL AREA : 75,564 SQFT

**FLOOR PLAN**  
SCALE: NOT TO SCALE



# STANFORD TRADING CENTER VIII